

SEIKO

Alarm Clock
Instruction Manual

Thank you for your purchase of our
SEIKO clock.
Please read this instruction manual
carefully before use.

HL054-1

FEATURES

- By pressing the SPEAK/SNOOZE button, illumination comes on, and at the same time, a voice informs you of the current time and date.
(When the alarm time or current time is adjusted, a voice informs you of the time being set.)
- An auto-speaking function informs you of the current time every one minute for 15 minutes.
- Time announcement sounds every hour (0th minute) when the hourly time announcement is set.
- The alarm consists of both voice and electronic beep sound.
(Alarm and time signal functions cannot be used simultaneously.)
- With the snooze function, the alarm starts ringing again even if it is stopped.
- The auto-stop function automatically stops the alarm after approximately five minutes.

LOCATION AND CARE OF YOUR CLOCK

- Avoid using your SEIKO clock in the following places:
 - Under conditions where the temperature is below -10°C or above 50°C.
 - e.g. In place exposed to direct sunlight, near heat or hot air caused by heating appliances, etc., or close to flames.
 - In moist, humid environments such as in a bathroom.
 - Places exposed to strong magnetic fields or vibrations.
- Care of your clock
Daily care
 - When cleaning the clock case, wipe it with a soft moist cloth.
 - If the clock case becomes excessively dirty, wipe it with a soft cloth moistened with a small amount of diluted detergent, and wipe again with a dry cloth.
 - Do not use chemicals such as benzene, thinner or alcohol, cleanser or brushes, to clean the clock case.
 - Do not expose the clock to insecticide or hair spray.

REMARKS ON BATTERIES

⚠ WARNING

<Remarks on alkaline batteries>
(1) Never attempt to short circuit, dismantle, or heat the alkaline battery, or place it in a fire. This may cause a leak of the alkaline solution inside the battery, and if the solution should get into your eyes, it will cause damage. Additionally, the battery may generate intense heat or explode.
(2) If your skin or clothing comes into contact with the alkaline solution, rinse with clean water. If the solution gets into your eyes, rinse eyes with clean water and consult a doctor immediately.

⚠ CAUTION

<Remarks on batteries>
Please be sure to observe the following correct battery usage. Misusing batteries may cause leakage or a battery explosion, which may result in a malfunction of the clock or personal injury.
(1) Insert batteries into the battery holders, locating the plus (+) and minus (-) ends correctly.
(2) If you replace batteries, replace all of them at one time with new ones as specified in this manual.
(3) Batteries used in this clock are not rechargeable. Never attempt to recharge the batteries.
(4) Do not attempt to solder anything directly to batteries.
(5) Do not expose batteries to direct sunlight, heat, or high humidity.
(6) When the clock stops, or it is no longer used, remove the batteries.
(7) As the initial batteries are inserted at the factory, their actual lives once in your possession may be shorter than the specified period.

LIQUID CRYSTAL PANEL

⚠ WARNING

If the liquid crystal panel of the clock is broken, care should be taken to avoid injury. In the case of any of the incidents below, take the following emergency steps ;
- If your skin is in contact with the liquid crystal
Gently wipe away, rinse your skin with clean water, and wash with soap and water.
- If the liquid crystal gets into your eyes
Rinse your eyes with clean water for more than 15 minutes, and consult a doctor immediately.
- If the liquid crystal is swallowed
Rinse the inside of the mouth, drink an excessive amount of water so as to induce vomiting, and consult a doctor immediately.

- Depending on the direction of the clock, the digital display may be faint or uneven.
- When the clock is operated in low temperatures, the response of the digital display may become slower.
- When the clock is operated in high temperatures, the liquid crystal panel may become dark and may not be readable.
- Do not touch the liquid crystal panel, as the digital display may become faint or uneven. If the panel is touched, leave it untouched for a while, and the display will return to normal.

SPECIFICATIONS

- Manual time setting: Loss/gain (monthly rate) is less than 30 seconds (at a normal temperature range between 5°C and 35°C)
 - Operational temperature range: between -10°C and +50°C (the display can be read between 0°C and +40°C)
 - Alarm: Voice and electronic beep sound which changes at three stages, auto-stop for approximately 5 minutes, snooze for approximately 5 minutes (the snooze function can be used repeatedly).
 - Automatic calendar: The calendar adjusts automatically for odd and even months including February of leap years from Jan. 1, 2000 to Dec. 31, 2099.
 - Time/Calendar display: Hour, minute, second, month, date, day of the week can be displayed.
12-hour time indication with AM/PM indicator and 24-hour indication are available.
 - Battery: AA alkaline batteries (JIS standard: LR6), 3 pcs
 - Battery life: Approximately 1 year
- * The specifications are subject to change without prior notice due to product improvement.

TROUBLESHOOTING

When the product does not operate normally, refer to the table below to check before requesting repair.
If replacing the batteries with new ones, use within the recommended period.

Symptom	Possible Cause	Treatment
Nothing is displayed. No sound is produced.	- There is no battery in the clock. - The battery charge is low. - The positive (+) and negative (-) portions of the battery are positioned incorrectly - The clock is reset improperly.	- Check the direction of the newly inserted batteries, and press the RESET button. - Reinsert the batteries correctly and make sure to press the RESET button.
The time or calendar is not displayed completely.	- The battery charge is low. - The clock is reset improperly. - Improper operation caused by static electricity, etc.	- Check the direction of the newly inserted batteries, and press the RESET button. - Reinsert the batteries correctly and make sure to press the RESET button.
The time or calendar is adjusted improperly.	- The battery charge is low. - The clock is reset improperly.	- Check the direction of the newly inserted batteries, and press the RESET button. - Reinsert the batteries correctly and make sure to press the RESET button.
The alarm does not ring.	- The "ALARM / HOURLY TIME ANNOUNCEMENT switch" is turned OFF. - Improper operation caused by static electricity, etc.	- Turn on the "ALARM / HOURLY TIME ANNOUNCEMENT switch". - Reinsert the batteries correctly and make sure to press the RESET button.

HOW TO USE THE CLOCK

■ Switches and buttons

- Illumination light (blue LED)

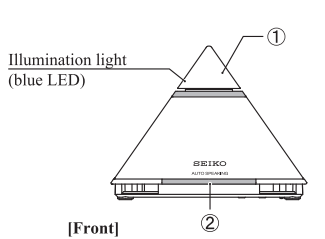

[Front]
- [Bottom]

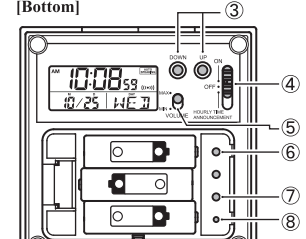

① SPEAK/SNOOZE button

 - If the SPEAK/SNOOZE button is pressed, a voice will inform you of the current time, date.
 - If this button is pressed while the alarm is ringing, the sound stops and the snooze function is activated. The alarm will ring again approximately 5 minutes later.
 - If this button is pressed, the illumination light comes on.

② AUTO SPEAKING button

 - If the AUTO SPEAKING button is pressed, you will be informed of the current time every one minute for 15 minutes.

③ UP/DOWN button

 - The UP/DOWN button is used to set the alarm time or the current time and date.

④ ALARM / HOURLY TIME ANNOUNCEMENT switch

 - ON: The alarm rings at the set time.
 - OFF: Both the alarm/hourly time announcement do not ring.
 - HOURLY TIME ANNOUNCEMENT: A voice will inform you of the hour (0th minute).
(The alarm does not ring.)

⑤ VOLUME switch

 - The VOLUME switch is used to change the volume to "MAX" or "MIN."

⑥ TIME/DATE SETTING button

 - The TIME/DATE SETTING button is used to set the current time or date manually.
(Press the button for more than 2 seconds).

⑦ MONITOR button

 - If the MONITOR button is kept pressed, the clock alarm will keep ringing regardless of the time.

⑧ RESET button

 - The RESET button is used to resume initial settings.
Make sure to press the button with an object having a thin end after the batteries are replaced.

■ Displays

Current Time (Hour, Minute, Second)

Selection of 12/24-hour indication
When changing the time indication method, select the 12-hour indication or 24-hour indication.

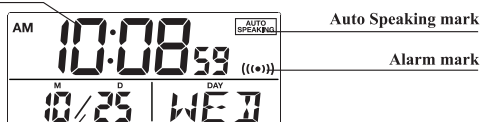

Calendar / Alarm time

When the “ALARM / HOURLY TIME ANNOUNCEMENT switch” is turned “OFF” or at the “HOURLY TIME ANNOUNCEMENT,” month and day are displayed, and when the “ALARM / HOURLY TIME ANNOUNCEMENT switch” is turned “ON,” alarm time is displayed.

- Check the included accessories before use.
- AA alkaline batteries (JIS standard: LR6), 3 pcs
 - One instruction manual

■ How to use the clock

Before using the clock, slowly peel off the protective film on the display.
(Black lines or spots may occur due to static electricity at this time. It returns to the normal status if left for a while.)

1. Insert the batteries (AA alkaline batteries (JIS standard: LR6), 3 pcs.

Slide the back cover of the battery in the arrow direction pushing the portion ① to open, and insert the batteries. Be sure to position the positive (+) and negative (–) correctly.

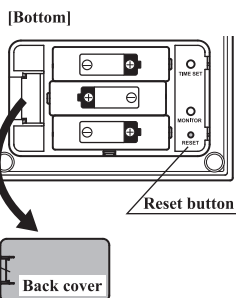

2. Press the RESET button with an object having a thin end.

Press the “⑧ RESET button” with an object having a thin end.
After all display details are turned on, the time shows “12:00 AM”.

Note: After replacing the batteries with new ones, be sure to press the “⑧ RESET button.”

3. How to use the alarm

① Press the “③ UP/DOWN button.”

The alarm time flashes, and a voice informs you that the alarm time setting mode has been set.

② Press the “③ UP/DOWN button” to set the alarm time.

- Every time after the “③ UP/DOWN button” is pressed, a voice informs you of the alarm time.
- If the “③ UP/DOWN button” is again kept pressed in alarm time setting status, the hour and minute digits advance quickly.
- If the “③ UP/DOWN button” is not pressed for more than approximately 5 seconds, the alarm time is automatically confirmed and the display returns to the NORMAL display.

③ Move the “④ ALARM/HOURLY TIME ANNOUNCEMENT switch” to ON.

A voice informs you the alarm time when an electronic beep sound is heard.

- The alarm mark ((••)) comes on, and display of month and day changes to display of alarm time.

④ Select “MAX” or “MIN” with the “⑤ VOLUME switch.”

4. How to stop the alarm

There are two ways to stop alarm.

[To completely stop the alarm]

Move the “④ ALARM/HOURLY TIME ANNOUNCEMENT switch” to OFF to stop the alarm.

- The ALARM mark ((••)) disappears.

[To ring the alarm again after approximately 5 minutes (Snooze function)]

When the “① SPEAK/SNOOZE button” is pressed, the alarm stops temporarily, and after approximately 5 minutes, it will start ringing again.

- While the snooze function is activated, the alarm mark ((••)) continues to flash.
- The snooze function can be used repeatedly.

After the alarm rings for approximately 5 minutes, it automatically stops (Automatic stop function).

The alarm mark ((••)) remains being displayed, and the alarm will ring again at the same time the next day.

OTHER FUNCTIONS

■ To set calendar and time

- ① Keep pressing the “⑥ TIME/DATE SETTING button” for more than 2 seconds.
- ② With each press of the “⑥ TIME/DATE SETTING button,” the selected item to be adjusted flashes in the order as shown in the figure below.
- ③ Set the date and time with the “③ UP/DOWN button.”
- ④ When selection of 12/24-hour indication is ended, press “⑥ TIME/DATE SETTING button” to change to the [NORMAL display].

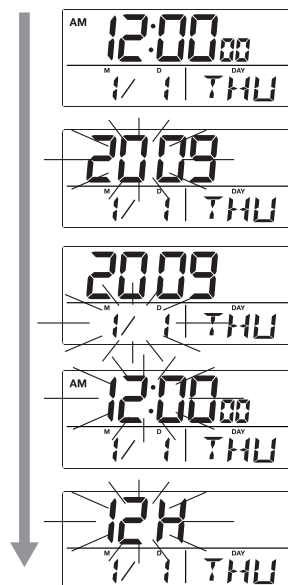

[NORMAL display]

Generally use the clock with the NORMAL display.

[YEAR SETTING display]

Press the “③ UP/DOWN button” to set the year.

The year can be selected from 2000 to 2999.

[MONTH /DATE SETTING display]

Press the “③ UP/DOWN button” to set the month and date.

The day will be automatically adjusted.

[TIME SETTING display]

Press the “③ UP/DOWN button” to set the time.

[12/24-HOUR INDICATION SETTING display]

Select the 12 hour indication or 24 hour indication with the “③ UP/DOWN button.”

Every time the “⑥ TIME/DATE SETTING button” is pressed during setting, a voice announces the contents to be set.

- After the “③ UP/DOWN button” is pressed, a voice announces the changed contents.
- If the “③ UP/DOWN button” is kept pressed, the time and date digits advance quickly.
- When the “① SPEAK/SNOOZE button” is pressed during setting, a voice announces the currently set contents.
- If the “③ UP/DOWN button” or “⑥ TIME/DATE SETTING button” is not pressed for more than approximately 5 minutes, the display automatically change to the [NORMAL display]. The time and date are those displayed just before they change to the [NORMAL display].

■ Sound demonstration

If the “⑦ MONITOR button” is kept pressed, the alarm sound (month and day, day of week, current time, electronic sound) continues to ring regardless of the time.

■ Sound volume change

Voice can be changed to “MAX” or “MIN” with the “⑤ VOLUME switch.”

■ Voice function

1. SPEAK function

When the “① SPEAK/SNOOZE button” is pressed, the illumination light comes on, and a voice announces the current time.

[Current time]

When the “① SPEAK/SNOOZE button” is pressed once in the NORMAL display, you are informed of the current time.

- 12-hour indication is selected “It is ○ : ○ (AM/PM)”
- 24-hour indication is selected “It is ○ : ○”

[Date and Day of week]

If the “① SPEAK/SNOOZE button” is pressed twice in NORMAL display (within 1 second), you are informed of the Date and Day of week.

2. HOURLY TIME ANNOUNCEMENT function

If the “④ ALARM / HOURLY TIME ANNOUNCEMENT switch” is set to HOURLY TIME ANNOUNCEMENT, the time is informed by voice every hour (0th minute).

- If it is set to “HOURLY TIME ANNOUNCEMENT,” the alarm does not ring

3. AUTO SPEAKING function

When the “② AUTO SPEAKING button” is pressed, you are informed of the current time every one minute for 15 minutes.

- The AUTO SPEAKING mark (AUTO SPEAKING) flashes during AUTO SPEAKING mode.
- If the “② AUTO SPEAKING button” is pressed again during AUTO SPEAKING mode, the AUTO SPEAKING function ends.



[In AUTO SPEAKING mode]

■ Caution

- The clock is equipped with a microcomputer. Abnormal display may be caused by interference from static electricity, etc.; however, this is not a malfunction. If this happens, press the “⑧ RESET button.”
- When the “⑧ RESET button” is pressed, the set time and other functions are all reset.
- After replacing the batteries with new ones, be sure to press the “⑧ RESET button.”